

Downlight with internal driver (2)

Step 1



Cut out 90mm opening on ceiling.

Step 2



Open the line pressing cover by screwdriver.

Step 3

A. Connect AC wire correspondingly.

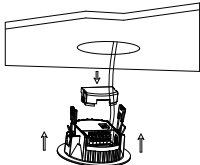

B. Then fix the line pressing clip.

Step 4

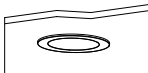

Release spring clips which will hold luminaire securely.

INSTALLATION MANUAL

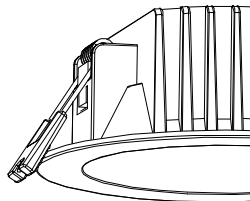

Important Safety Instructions

Basic safety precautions should always be followed when installing, including the following:

1. Read all instructions.
2. Licensed electrician for installation only.
3. Always ensure the power is OFF and the fitting has cooled down before performing any maintenance, cleaning, changing the globe or adjustment to the fitting.
4. Do not install any luminaire near the heat source.
5. Do not exceed the nominal supply voltage or amperage ratings.
6. To avoid injury or damage to the fitting, please ensure that power leads and screws are secure before connecting the power.
7. The product is IC-4 luminaire.

Installation Instructions

Fig 1: Installation Spacing

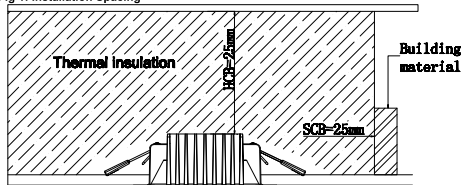

RISK OF FIRE – Required clearance from structural members and building elements

SCB=25mm HCB=25mm MIC=0mm SCL=0mm

HCB: Height clearance to building element

MIC: Minimum insulation clearance

SCL: Side clearance to insulation

SCB: Side clearance to building element

Warning:

Product modification and improper installation are not valid for warranty!

WARNING-RISK OF OVERHEATING OR FIRE IF THE CLEARANCE DISTANCES ARE COMPROMISED

non replaceable light source

light source which is a non replaceable part of the luminaire either because it cannot be replaced without breaking or destroying the luminaire or because it is enclosed under a cover fixed by screw or similar fixing means designed to be used only once and which is not possible to be opened.

For type Y attachments:

if the external flexible cable or cord of this luminaire is damaged, it shall be exclusively replaced by the manufacturer or his service agent or a similar qualified person in order to avoid a hazard.

Tab 1: Ceiling cutout reference table.

Downlight dia (inch)	3
Ceiling Cutout (mm)	90-95

NOTE: Before installation, please check the IP label on the luminaire to choose the right place to install.

IP20/IP40	Indoor use only, do not use in wet or damp place.
IP54	Suitable for indoor areas including bathrooms and covered/sheltered areas such as porches.

NOTE: Before installation, please check the information of driver as below.

Non-dim	Can not be used with any dimmer.
Triac dim	Compliable with recommended TRIAC dimmers, dimming range 8-100%.

Installation Procedure

WARNING

1. Switch off before installation.
2. Switch on only after complete installation and examination of the circuit.
3. Professional electrician for installation and maintenance only.
4. This solution requires that the number of single-channel parallel lamps cannot over 30PCS.



Turn Off power supply before starting any installation. Read instructions & check you have all the tools & accessories to complete the installation correctly.

Downlight with internal driver (1)

For the product with Slide Switch of CCT Selection, please select the light 3CCT(WW/NW/CW) before installation.

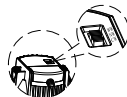

Step 1



Cut out 90mm opening on ceiling.

Step 2



Connect power supply.

Step 3 A. Press spring clips upward



B. Push downlight into position

Step 4



Release spring clips which will hold luminaire securely.