

INSTALLATION MANUAL

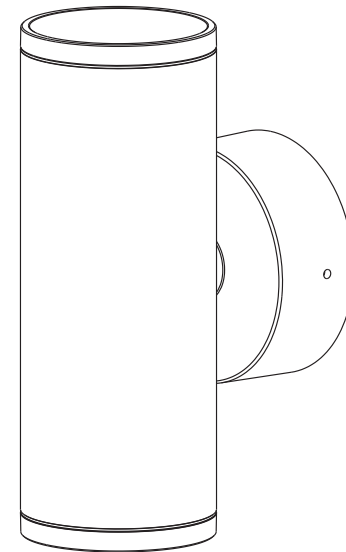

LED UP/DOWN

WALL LIGHT

UDL10W
UDL27W

Important Safety Instructions

Basic safety precautions should always be followed when installing, including the following:

1. Read all instructions.
2. Licensed electrician for installation only.
3. Always ensure the power is OFF and the fitting has cooled down before performing any maintenance, cleaning, changing the globe or adjustment to the fitting.
4. Do not install any luminaire near the heat source.
5. Do not exceed the nominal supply voltage or amperage ratings.
6. To avoid injury or damage to the fitting, please ensure that power leads and screws are secure before connecting the power.

Installation Procedure

WARNING

1. Switch off before installation.
2. Switch on only after complete installation and examination of the circuit.
3. Professional electrician for installation and maintenance only.



Turn Off
Power Supply

Turn Off power supply before starting any installation. Read instructions & check you have all the tools & accessories to complete the installation correctly.

Installation

Step 1

Take out the lamp and accessories.

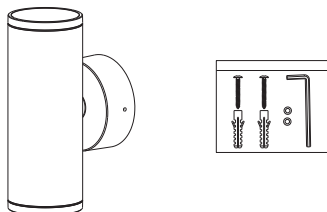

Step 2

Take out the base from the lamp body.

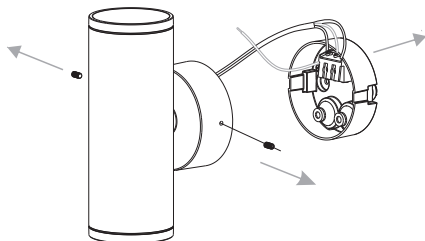

Step 3

Fix the base on the wall and make the wires through the hole of the base.

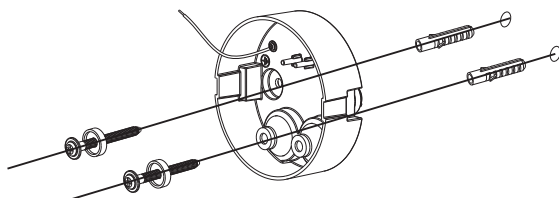

Step 4

Set the wires respectively.

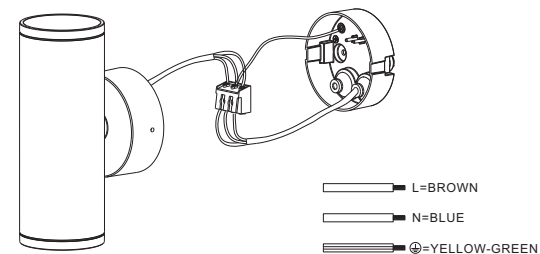

Step 5

Get the lamp fixture back to the base and fix it well.

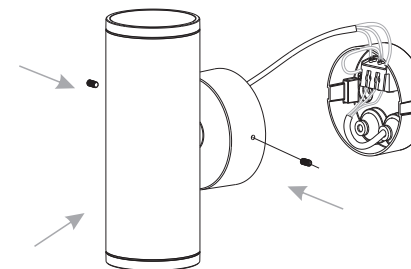

Step 6

Switch on after complete installation.

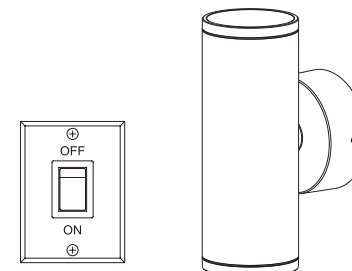

The light source of this luminaire is not replaceable; when the light source reaches its end of life the whole luminaire shall be replaced.