

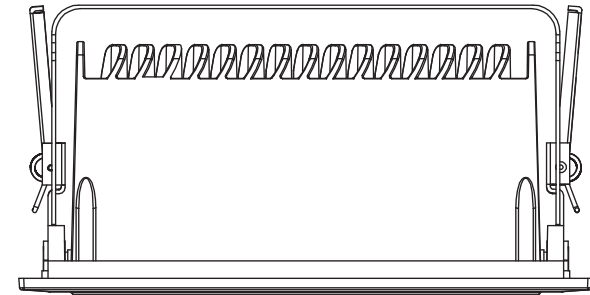

INSTALLATION MANUAL



 1800 909 306

 nedlandsgroup.com.au

 sales@nedlandsgroup.com.au

LED

SHOPLIGHTER

LED-SL35W

Safety Instructions

- Switch off before installation.
- Licensed electrician for installation only.
- Non-dimmable version, not for use with light dimmers.
- Dimmable Version, if it is triac dim, for use with triac dimmer.
- Product modification is not valid for warranty.

Production Specification

IP Rating:	IP20 / IP65
Voltage:	See details on package
Wattage:	See details on package
Ambient Temperature:	-20°C~+45°C
Storage Conditions:	-20°C~+65°C

How to Install

- Subject to Figure 1 & Table 1 for installation place and conditions
- Follow Figure 2 install steps to finish installation

RISK OF FIRE - Required clearance from structural members and building elements
SCB=25mm HCB=25mm

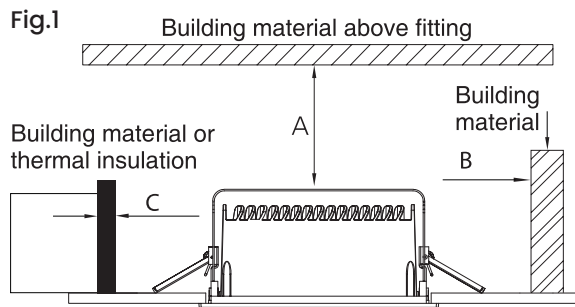

Tab

A-gap above the top of fitting	25mm
B-side gap to structural membrane	25mm
C-the gap to thermal insulation	25mm

How to Install (continued)

Fig.2

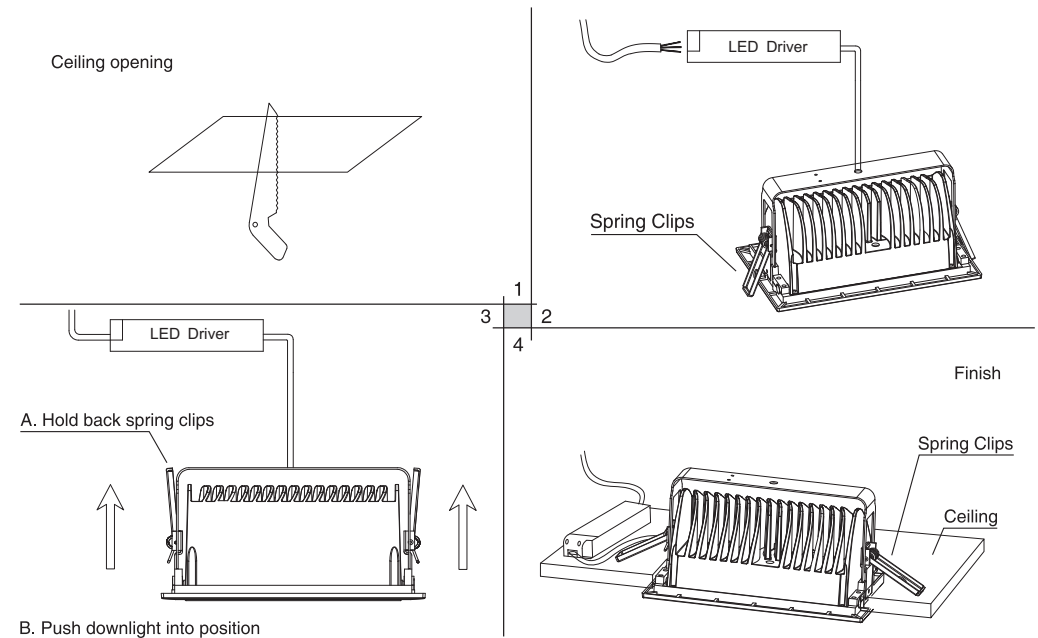

Warning:

Input wire diameter $\geq 0.75\text{mm}^2$;
Product modification and improper installation are not valid for warranty!