

INSTALLATION MANUAL

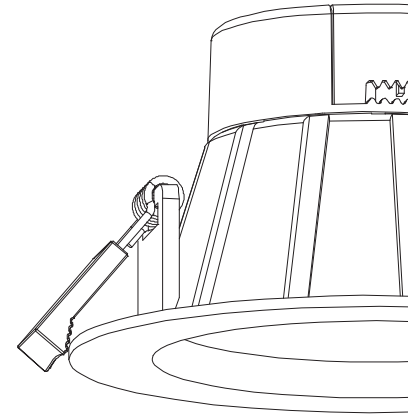

1800 909 306

nedlandsgroup.com.au

sales@nedlandsgroup.com.au

LED

DOWNLIGHT

ID7W, ID8W

Important Safety Instructions

Basic safety precautions should always be followed when installing, including the following:

1. Read all instructions.
2. Licensed electrician for installation only
3. IP54 for indoor use only
4. Always ensure the power is OFF and the fitting has cooled down before performing any maintenance, cleaning, changing the globe or adjustment to the fitting.
5. Do not install any luminaire near the heat source.
6. Do not exceed the nominal supply voltage or amperage ratings.
7. To avoid damage to the fitting, please ensure that power leads and screws are secure before connecting the power.



Installation Instructions

Fig 1: Installation Spacing

The fitting has an insulating ceiling type IC-4 rating. Building material and thermal insulation that can safely be exposed continuously to temperatures up to 90 °C may abut and cover the luminaire. If the building material cannot meet this condition, the minimum clearance of 25mm is required. See Figure 1 :

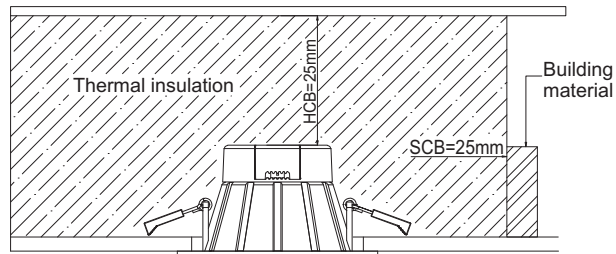

Tab 1: Ceiling cutout reference table.

Downlight dia (inch)	2.5	3	4	6	8
Ceiling Cutout (mm)	70-75	90	120	160	190

NOTE: Before installation, please check the IP label on the luminaire to choose the right place to install.

IP20/IP40	Indoor use only, do not use in wet or damp place.
IP44/IP54	Suitable for indoor areas including bathrooms and covered/sheltered areas such as porches.
IP65	Suitable for outdoor areas, not suitable for water immersion.

NOTE: Before installation, please check the information of driver as below.

Non-dim	Can not be used with any dimmer.
Triac dim	Compliable with recommended TRIAC dimmers, dimming range 8-100%.

Installation Procedure

WARNING ⚡

1. Switch off before installation.
2. Switch on only after complete installation and examination of the circuit.
3. Professional electrician for installation and maintenance only.
4. Risk of overheating of fire if the clearance distances are compromised.

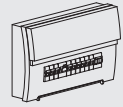

Turn Off Power Supply

Turn Off power supply before starting any installation. Read instructions & check you have all the tools & accessories to complete the installation correctly.

Downlight with internal driver

Please select the colour temperature before installation:
 WW: 3000K
 NW: 4000K
 CW: 5700K

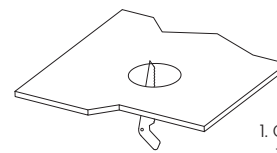
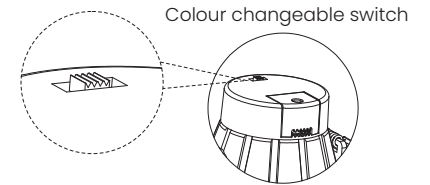

1. Cut a hole according to the cutout size of led downlight.

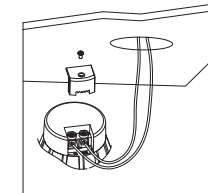

2. Use screw-driver to open the driver terminal cover on the back of downlight; feed the main AC wire L, N. in terminal block respectively, then fix the cover back.

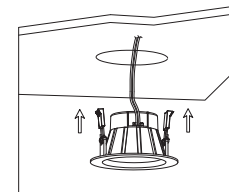

3. Hold back the spring clip then push the downlight into the hole.

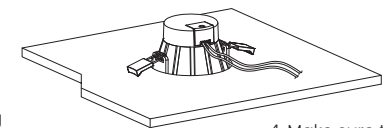

4. Make sure the downlight fixed tightly in ceiling, turn on the power (Fig 1).

RISK OF FIRE – Required clearance from structural members and building elements

SCB=25mm HCB=25mm

Warning:

Input wire diameter $\geq 0.75\text{mm}^2$;
 Product modification and improper installation void the warranty!