

Dimension: (Unit: mm)

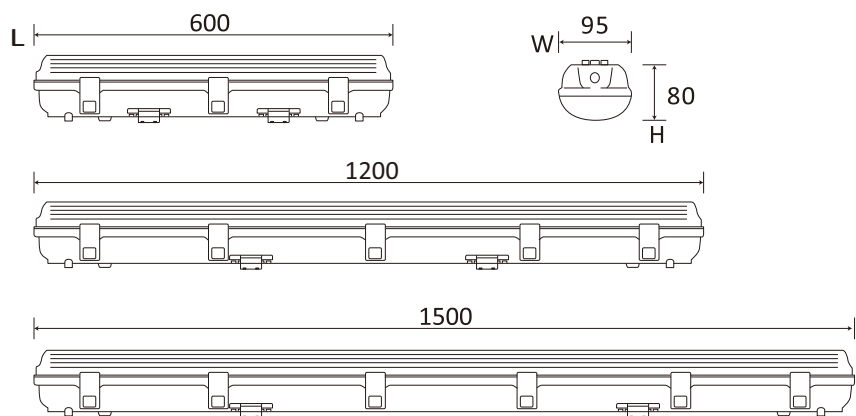

Please read instructions carefully before assembling and installation:

- Make sure the products are securely installed.
- The housing might become hot after operation.
- Consult with the manufacturer before maintenance.
- Turn OFF the power before installation and maintenance.
- If the pc cover is damaged, the luminaire shall be destroyed.
- This product must be installed and maintained by certified electrician.
- Primary use weatherproof luminaires for commercial and industrial buildings.
- Make sure the construction is strong enough to support the products.
- The product belongs to Class I.If necessary, please connect the ground line to terminal block.



INSTALLATION MANUAL

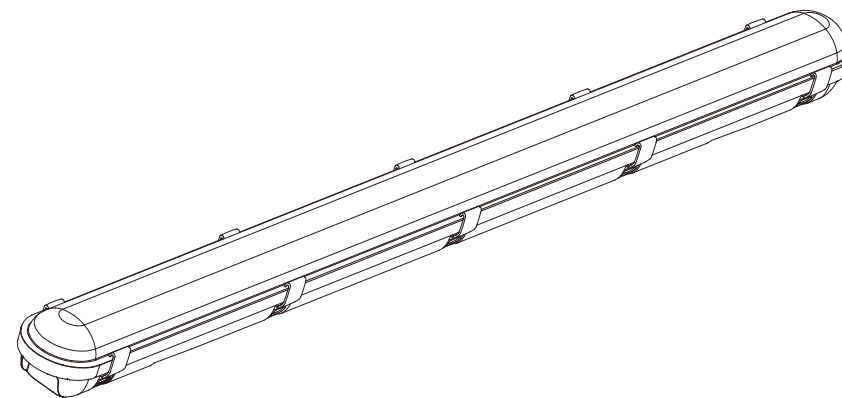

LED WEATHERPROOF

BATTEN

WP18W-CC
WP36W-CC



1800 909 306
 nedlandsgroup.com.au
 sales@nedlandsgroup.com.au

Installation Instructions

1. Mounting Buckles x 2 PCS with tightening screws x 4 PCS

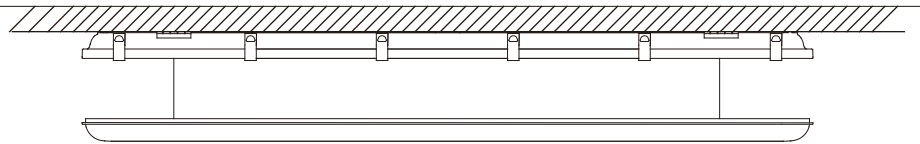
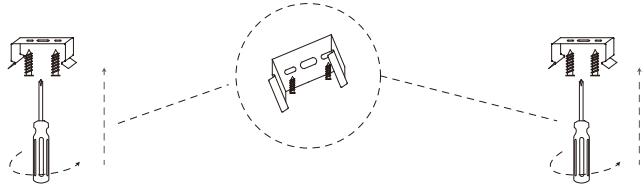

2. Ceiling Mounted

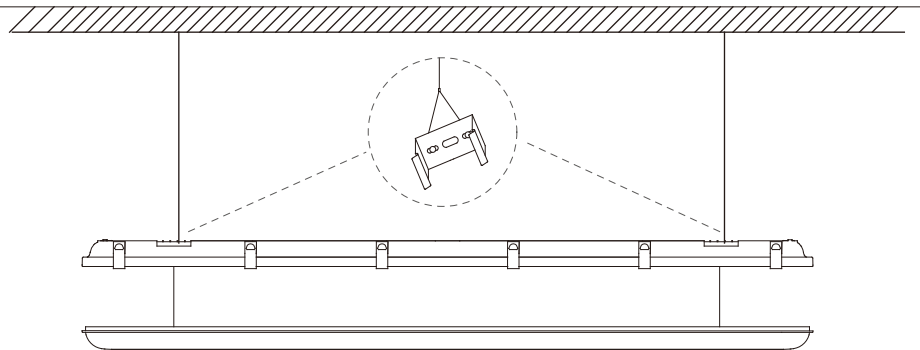

3. Suspension Mounted

4. General wiring diagram

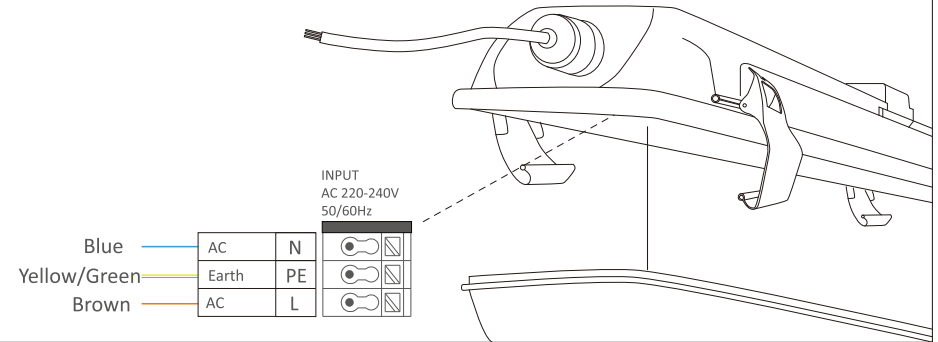

5. Emergency wiring diagram

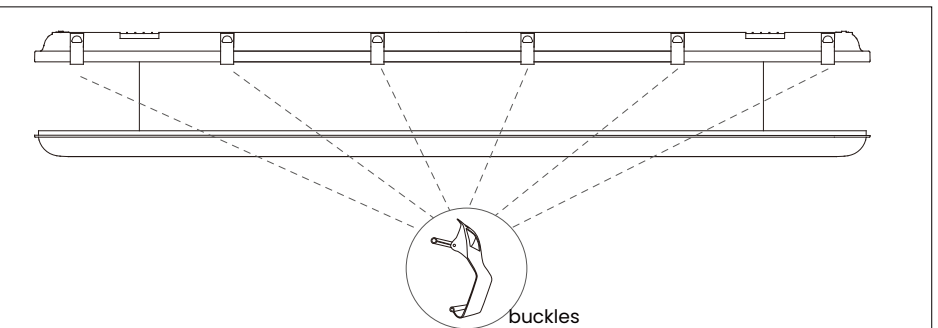
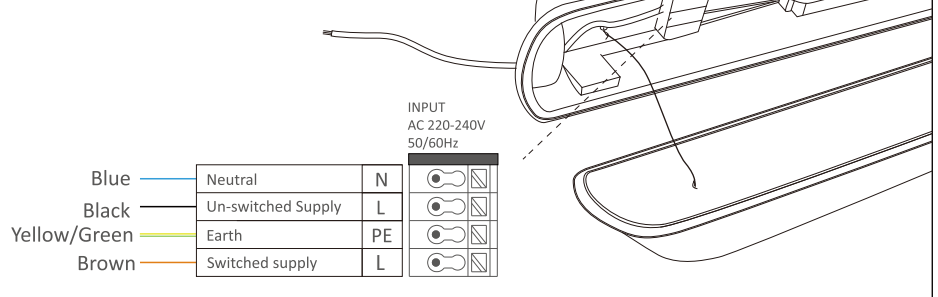

Finally, close the side buckles then turn on.

