

## INSTALLATION MANUAL

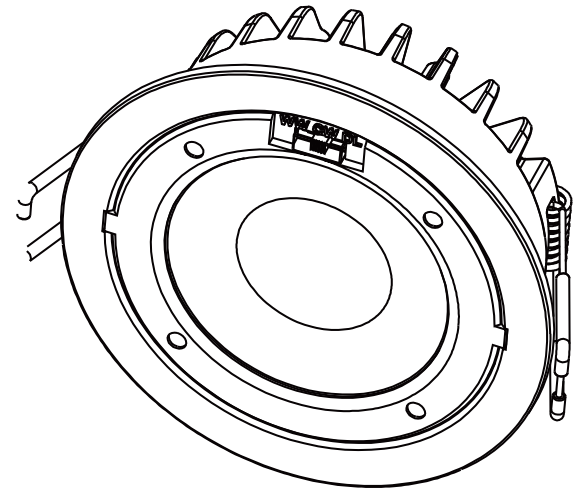

## Warning

1. Before installation or maintenance ensure that the mains supply to the luminaire is switched off and the circuit supply fuses are removed or circuit breaker turned off.
2. A qualified electrician MUST be consulted or used for the installation of this luminaire.
3. The luminaire must be installed to their relevant building regulations.
4. Check that the total load on the circuit, including when this luminaire is fitted, does not exceed the rating of the circuit cable fuse or circuit breaker.



## Technical Specifications

Input Voltage:	200-240VAC 50/60Hz
Power:	12W
Beam Angle:	60 degree
IP Rating:	IP65/IP44
PF:	>0.9
Cut Out:	90mm
Tri Colour:	3000K, 4000K, 6000K
Lumens:	900, 1000, 950

## Dimensions

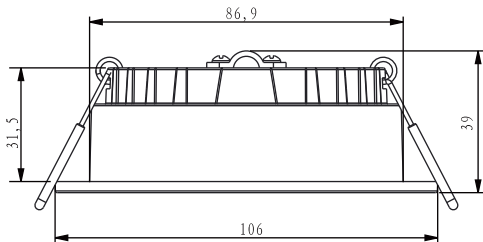

## Installation Instructions

1. Switch off power
2. Prepare cut-out hole in your surface to specified dimensions as stated in above drawing.

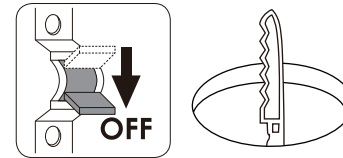

3. Select desired colour output via front mounted switch -WW -3000K, CW-4000K, DL-6000K

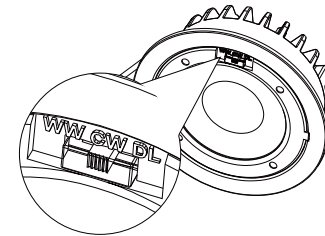

4. Connect the mains power cable to the driver

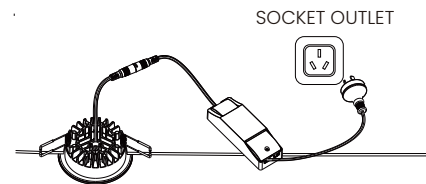

5. Place driver into recess then push back spring clips and insert luminaire into recess.

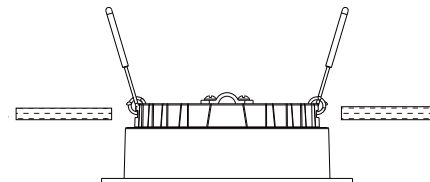

6. Place one of the supplied magnetic bezels to complete installation.

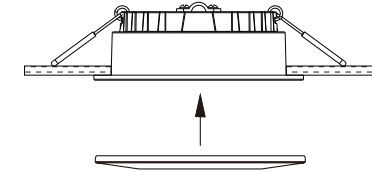

7. Switch power on at circuit

### Note:

For high voltage circuit insulation testing disconnect mains input supply first



(Do not circuit test using a megger)

### Changing Colour Temperature

To change colour temperature after installation



- a. Ensure the power is switched off.
- b. Remove magnetic bezel and switch to desired colour temperature
- c. Replace bezel
- d. Switch power on at circuit

### Installation Spacing

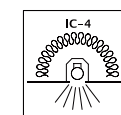
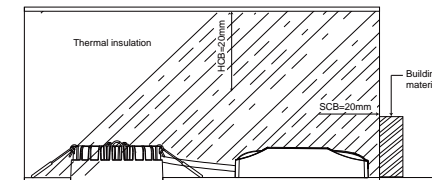

RISK OF FIRE - Required clearance from structural members and building elements

SCB=20mm

HCB=20mm