

LED WALL LAMP

Important Safety Instructions:

Basic safety precautions should always be followed when installing, including the following:

1. Read all instructions.
2. Licensed electrician for installation only.
3. Always ensure the power is OFF and the fitting has cooled down before performing any maintenance, cleaning, changing the globe or adjustment to the fitting.
4. Do not install any luminaire near the heat source.
5. Do not exceed the nominal supply voltage or amperage ratings.
6. To avoid injury or damage to the fitting, please ensure that power leads and screws are secure before connecting the power.

Installation Procedure

WARNING

1. Switch off before installation.
2. Switch on only after complete installation and examination of the circuit.
3. Professional electrician for installation and maintenance only.



Turn Off
Power Supply

Turn Off power supply before starting any installation. Read instructions & check you have all the tools & accessories to complete the installation correctly.

Installation (A)

Step1

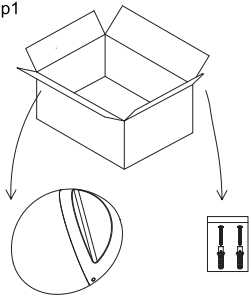

Take out wall light and accessory pack from package.

Step2



Fix the plastic anchor into wall.

Step3

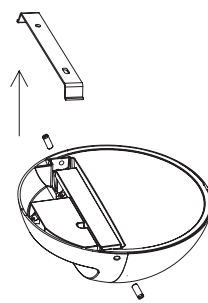

Loose screws and take out the bracket from lamp body.

Step4

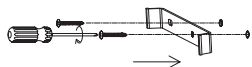

Fix the bracket on the wall with screws.

Step5

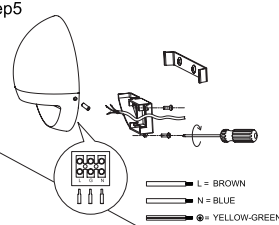

Open junction box, connect "L", "N", "G" wires to terminal block respectively and lock the driver box, then fix the light on the wall.

Step6

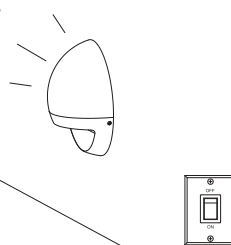

Switch on after complete installation.

Installation (B)

Step1

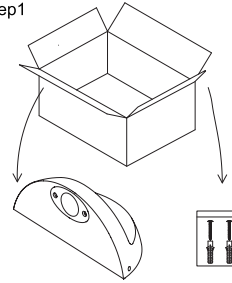

Take out wall light and accessory pack from package.

Step2

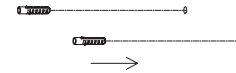

Fix the plastic anchor into wall.

Step3

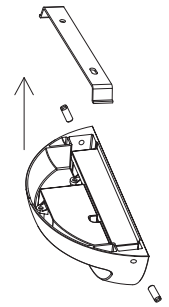

Loose screws and take out the bracket from lamp body.

Step4

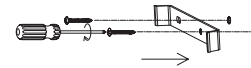

Fix the bracket on the wall with screws.

Step5

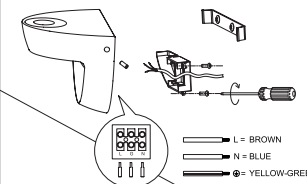

Open junction box, connect "L", "N", "G" wires to terminal block respectively and lock the driver box, then fix the light on the wall.

Step6

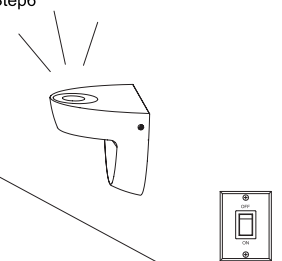

Switch on after complete installation.

Warning: Production modification and improper installation are not valid for warranty.